

AIR-TIGHT BEARING PROTECTOR **SPORT MODEL**

Keeps corrosive water & contaminants off your bearings

Patented Air-Tight Hub Design-

Air-Tight Chamber designed to keep water from intruding into the bearing compartment.

Easy to Install- Can be installed on your trailer in minutes.

Diaphragm- Confirms seal integrity at a glance. Air pressure of 5-10 psi can be easily monitored and maintained.

Fail Safe- Future bearing failures can be immediately detectable.

Environmentally Friendly-

Ensures grease stays inside the hub where it belongs.

Super Seal - Long lasting, heavy-duty molded seal with double lip protection, ensures water and contaminants will not breach into bearing compartment.

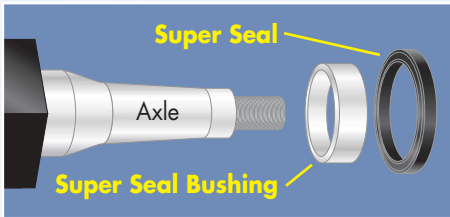

Other Wheel Hub Devices are Not Water Tight & Can't be Monitored-

- During Hub heating (from driving), and the cooling (from submersion), a vacuum is created that sucks water into the hub. Spring-Type bearing devices cannot keep all the water out. Water remains inside the hub cavity causing corrosion to the bearings and axle.
- Spring systems cannot be seen or tested for accurate operation and give no indication of bearing failures until the wheel falls off on the highway.



Air-Tight, LLC

www.airtighthubs.com

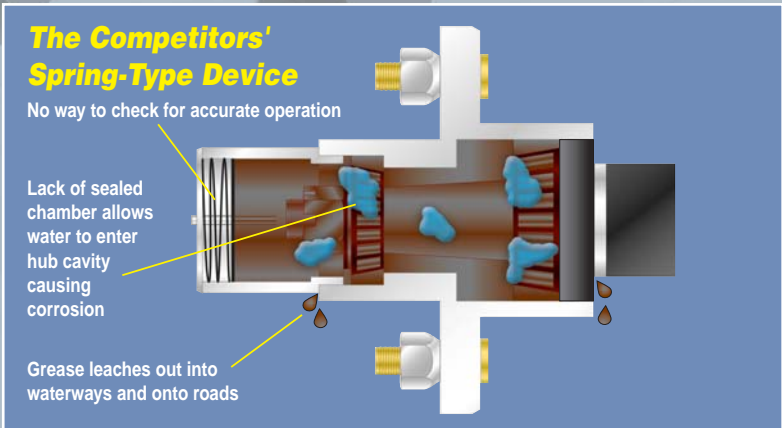
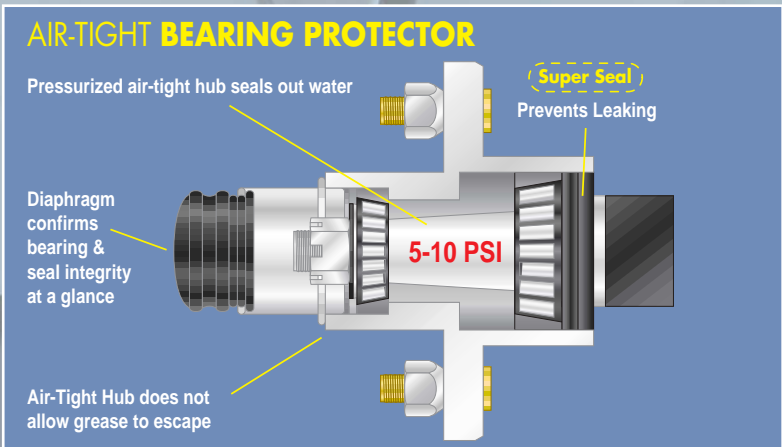

3500 lb Axle/5 Lug Technical Data (1-3/8" by 1-1/16" Bearing Size)

Assembly Components

- Air Cap
- Diaphragm
- Super Seal™
- Bonding agent
- Sport needle
- Stainless Steel Bushing
- 3 different inner dimension size shims

With the Sport model, use a manual pump with a sports needle, insert the needle into the center of the diaphragm and pump up until the diaphragm expands outwards approximately 3/4 of an inch. That will pressurize the hub with approximately 5 to 10 psi. Do not over pressurize the diaphragm. Your indicator of a pressurized hub is by visually seeing where the diaphragm position is relative to the face of the cap.

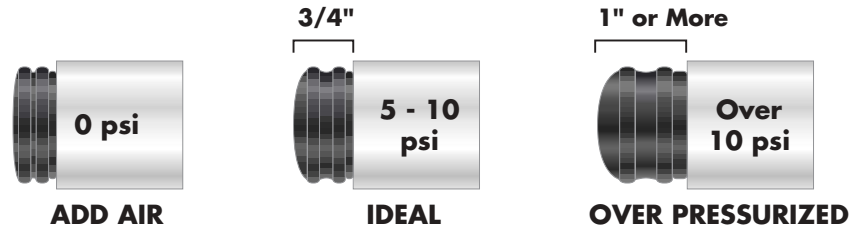

Ideally, the diaphragm should be inflated approximately 3/4 of an inch past the cap.
Lubricate sport needle with grease whenever inflating.

Universal Kit (Sport Model) Kit Part # AT-35US

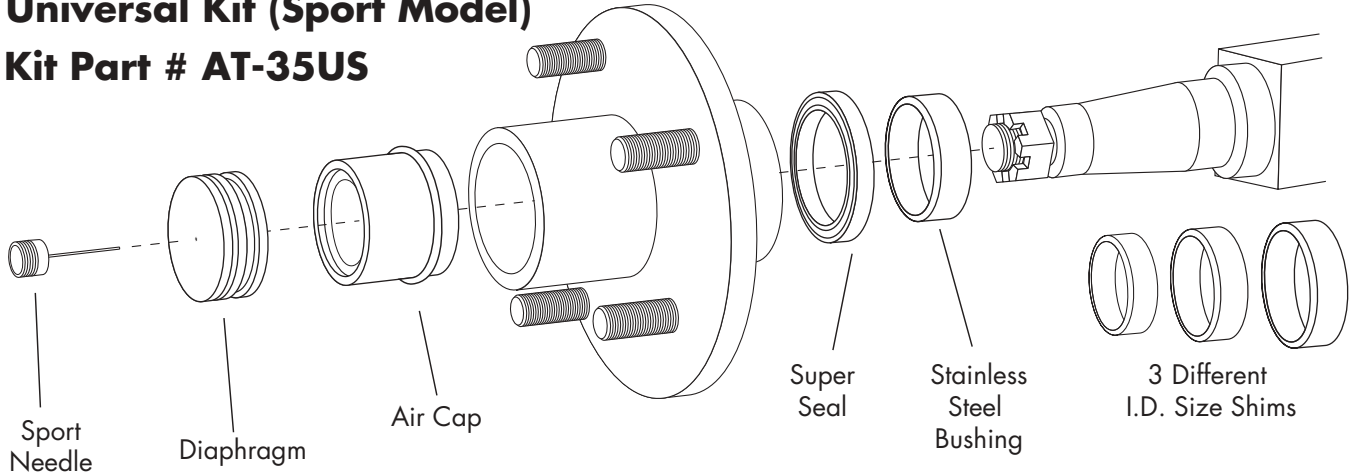

Air-Tight Parts List	Part #	Air-Tight Parts List	Part #
Air Cap	AT-3	Bonding Agent	AT400
Diaphragm	AT-10	Stainless Steel Bushing	AT172
Sport Needle	AT-1	Super Seal	AT300
		3 Different I.D. Size Shims	AT303

Universal Kit Summary

All the parts in this kit will fit a 3500lb/5lug (1-3/8" x 1-1/16") bearing hub. The size of the spindle, where the seal rides will vary from manufacturer, when the sleeve is removed. (Removal of their sleeve is necessary due to they are not sealed to the spindle.)
 Exception: U.F.P. Spindle (noted in directions).

The stainless steel bushing and (3) different inner dimension size shims cover all the different spindle sizes you will experience in the assembly of the bushing to the spindle.

The Universal Kit will eliminate the need to measure your spindle. Air-Tights Universal Kit comes with (3) different inner dimension size shims. One or more of the shims may be used in putting on the stainless steel bushing.

One of (2) things will happen:

1. Air-Tights stainless steel bushing will fit your spindle snug, without the use of a shim.
2. One of the (3) shims will fit your spindle snug so Air-Tights stainless bushing can bond directly on top of the shim.

The 6 lug and 8 lug kits are also available. See your local dealer or visit us on our website at www.airtighthubs.com for more information.